

REVISIONS

SCHEDULES:

ALL DIMENSIONS ARE IN mm
DO NOT SCALE THE DRAWING

DRG.No.
DATA.ZKM/31005

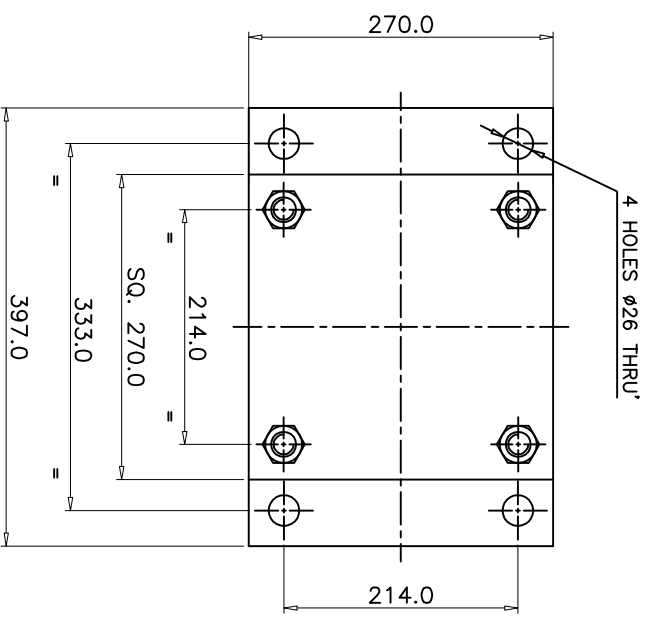
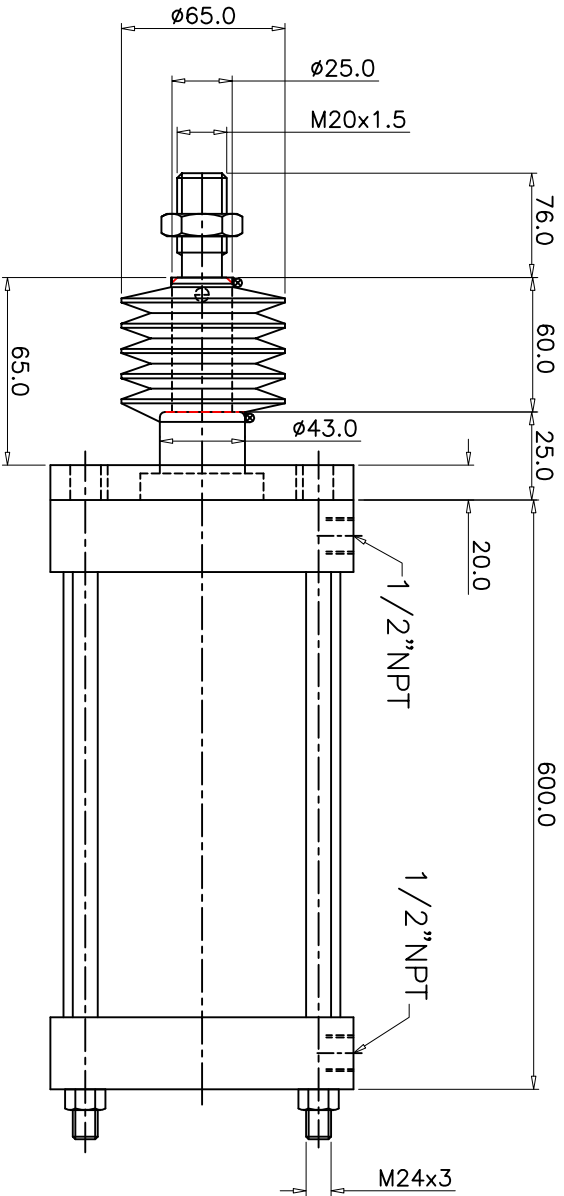

TECHNICAL DATA

- 1. CYLINDER TYPE : DOUBLE ACTING NON CUSHIONED
- 2. CYL. BORE DIA : 10" (254.0)
- 3. STROKE : 435
- 4. PISTON ROD DIA : 25
- 5. OPERATING PRESSURE : 2-10 bar
- 6. OPERATING TEMP. MAX. : +80 °C
- 7. MOUNTINGS : FRONT FLANGE MTG. STYLE-G (SPL.)

REMOVE BURRS AND SHARP CORNERS

NUCON INDUSTRIES PRIVATE LIMITED

ASSEMBLY:
10" BORE 435mm STROKE NON-CUSHIONED SPL. CYLINDER

SCALE: NTS TITLE:

DATA SHEET



DRAWN	D.SATISH	20.10.2006
CHECKED		
APPROVED		
DRG.No.	DATA.ZKM/31005	
SHEET	OF	