

REVISIONS

SCHEDULES:

ALL DIMENSIONS ARE IN mm
DO NOT SCALE THE DRAWING

DRG.No.
ZRM/10002

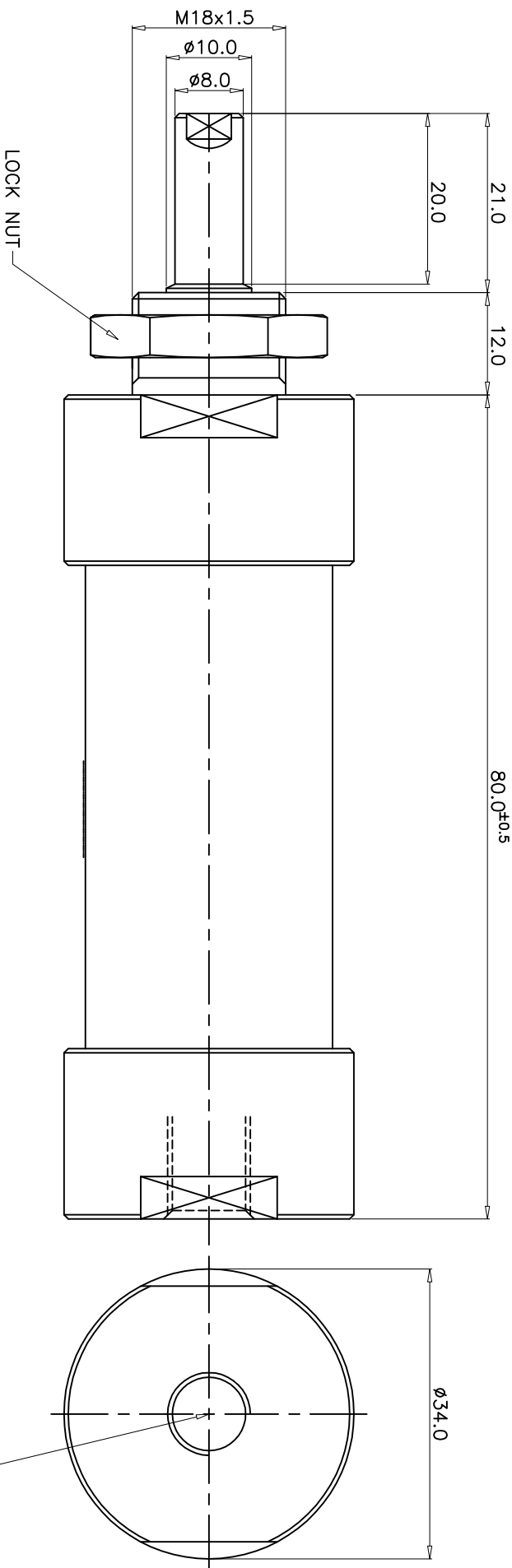

TECHNICAL DATA

- 1. CYLINDER TYPE : SINGLE ACTING MIDGET CYLINDER
- 2. BORE DIA : 25
- 3. STROKE : 10
- 4. PISTON ROD DIA : 10
- 5. OPERATING PRESSURE : 2 - 10 bar
- 6. OPERATING TEMP. MAX. : + 80°C

REMOVE BURRS AND SHARP CORNERS

GENERAL TOLERANCES		MATERIAL:		FINISH:	
Dimensions	0.1 0.3 0.5 1.0 2.0 4.0 10.0	MATERIAL:		FINISH:	
Tolerances ±	0.1 0.2 0.3 0.5 0.8	MATERIAL:		FINISH:	
Angular ±1/2°	Concentricity φ 0.1	MATERIAL:		FINISH:	
ASSEMBLY:					
M/s D.M. INTERNATIONAL					

SCALE: 2:1	TITLE:
	AIR CYLINDER
DRAWN	D.SATISH
CHECKED	
APPROVED	
DRG.No.	ZRM/10002
SHEET	OF