

REVISIONS

SCHEDULES: ZM/925/76/D/SPL

DRG.No.  
DATA.ZRM/41003

ALL DIMENSIONS ARE IN mm  
DO NOT SCALE THE DRAWING

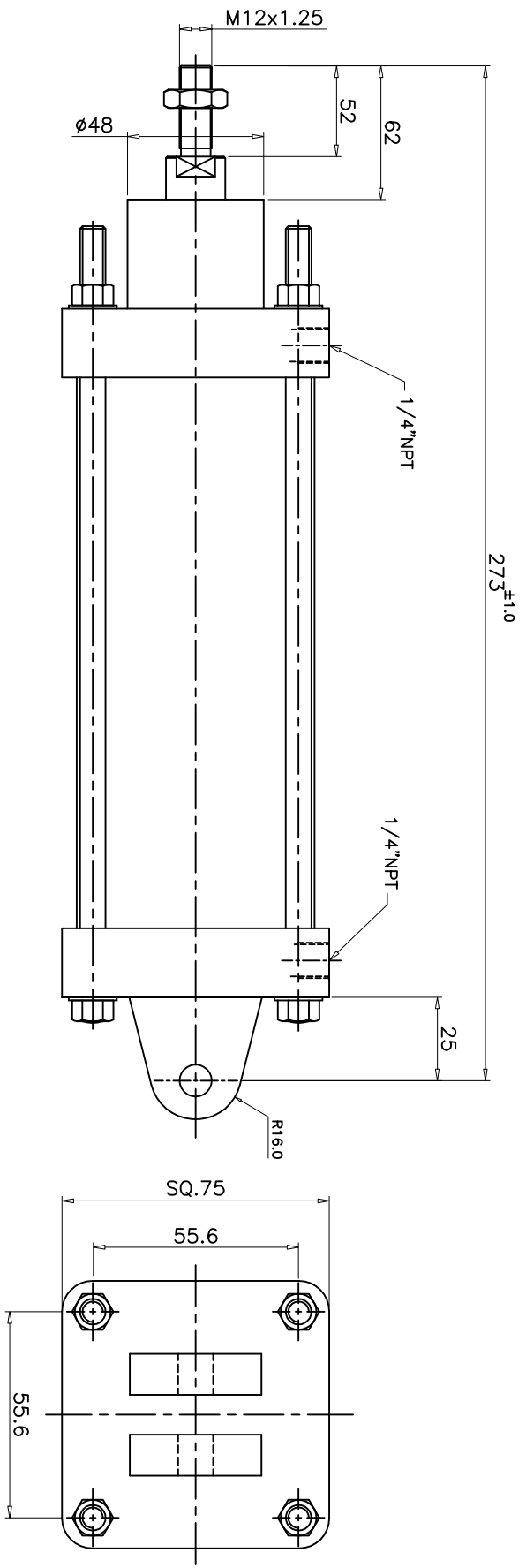

TECHNICAL DATA

- 1. CYLINDER TYPE : DOUBLE ACTING NON CUSHIONED
- 2. BORE DIA : 2.5"
- 3. PISTON ROD DIA : 25.4 mm
- 4. STROKE : 76 mm
- 5. OPERATING PRESSURE : 2 - 10 bar
- 6. OPERATING TEMP. MAX. : + 80°C (NITRILE)
- 7. MOUNTINGS : OPTION : + 150°C (VITON)
- : REAR CLEVIS MTG. STYLE-D (SPL)
- (INTEGRAL REAR END COVER)

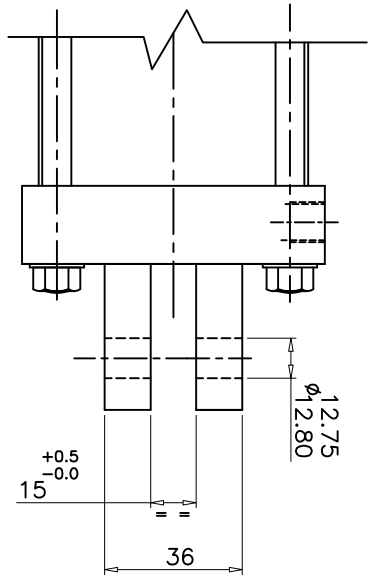

REMOVE BURRS AND SHARP CORNERS

NUCON INDUSTRIES PRIVATE LIMITED

ASSEMBLY:		DRAWN		D.SATISH		24.10.2006	
63mm BORE 76mm STROKE CAST IRON NON-CUSHIONED CYLINDER		CHECKED					
SCALE: NTS		APPROVED					
TITLE:		DRG.No.		DATA.ZRM/41003			
DATA SHEET		SHEET		OF			