

REVISIONS

SCHEDULES: ZM/940/162/D/SPL

DRG.No.  
DATA.ZRM/41014

ALL DIMENSIONS ARE IN mm  
DO NOT SCALE THE DRAWING

512±1.0

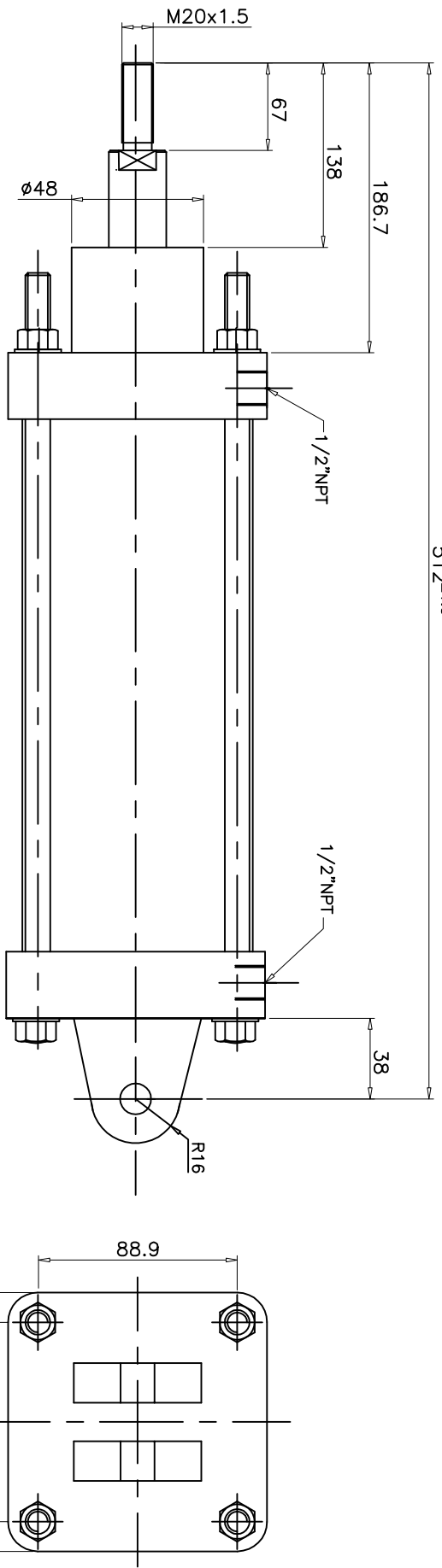

### TECHNICAL DATA

- 1. CYLINDER TYPE : DOUBLE ACTING NON - CUSHIONED
- 2. BORE DIA : 4"
- 3. PISTON ROD DIA : 25.4 mm
- 4. STROKE : 162 mm
- 5. OPERATING PRESSURE : 2-10 bar
- 6. OPERATING TEMP. MAX. : + 80°C (NITRILE)
- 7. MOUNTINGS : REAR CLEVIS MTG. STYLE-D (SPL)  
(INTEGRAL REAR END COVER)

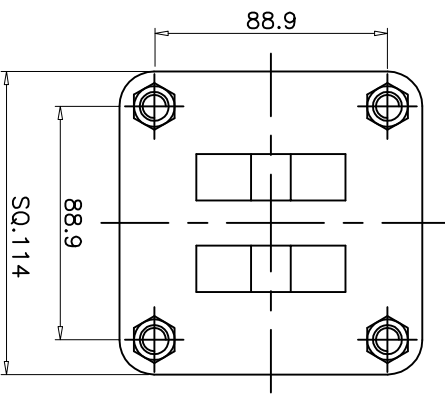
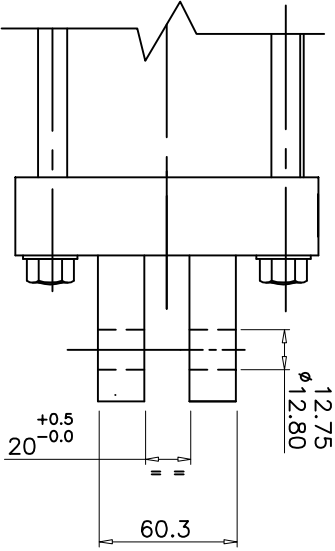

REMOVE BURRS AND SHARP CORNERS

# NUCON INDUSTRIES PRIVATE LIMITED

ASSEMBLY:

100mm BORE 162mm STROKE CAST IRON NON-CUSHIONED CYLINDER

SCALE: NTS

## DATA SHEET



DRAWN	D.SATISH	22.09.2006
CHECKED		
APPROVED		
DRG.No.	DATA.ZRM/41014	
SHEET	OF	